



SGL Series Cable Assembly

(248) 356-2839

Primary transgun power cable meets GM MDS610/ 615 specification with urethane strain relief for long life

FEATURES

- Maximum cable life design to reduce downtime
- Meets GM MDS610 / 615 specification
- Urethane Strain Aid utilized in design
- Straight and 90 degree versions are available
- 2 AWG/ 3 cond. And 4 AWG/ 3 cond. Versions are available
- 2000 Volt rated
- 90 degree Celsius rating
- Very cost competitive
- Custom lengths available for greater cost savings



DIMENSIONS - 90 DEGREE

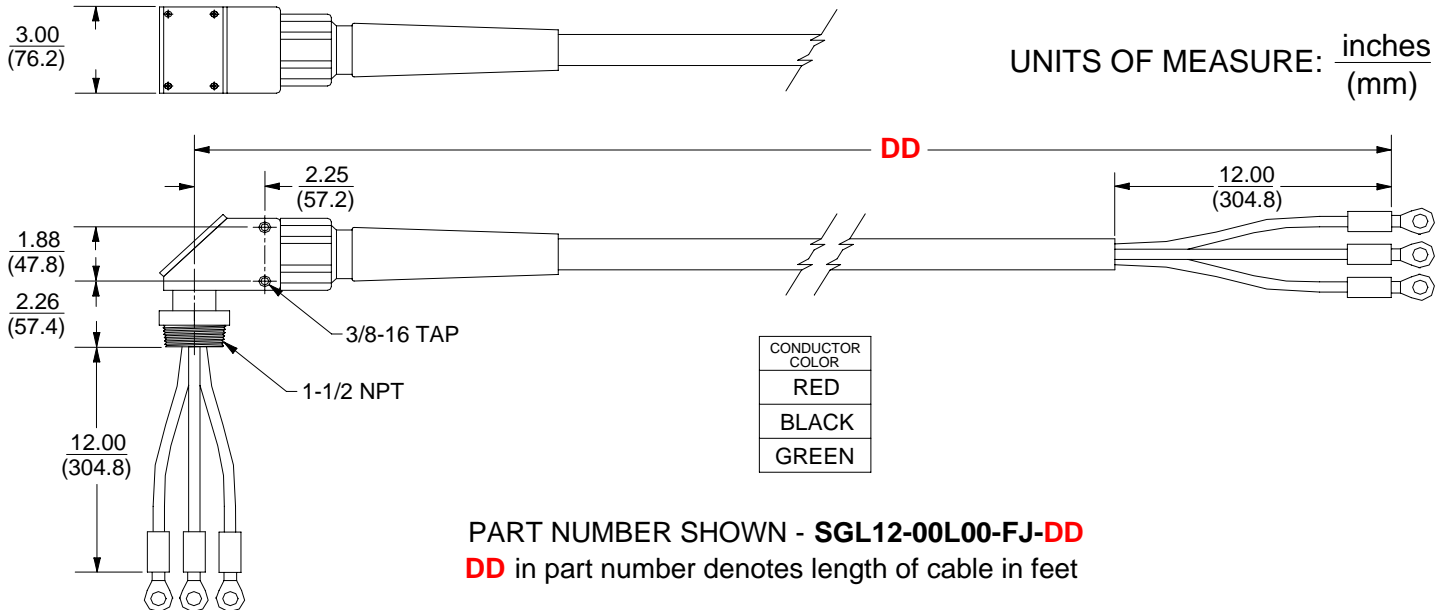

Notice: The information contained herein is, to the best of our knowledge, true, accurate and reliable. Since procedures and conditions under which these products may be used are beyond our control, no warranty, expressed or implied, is made to their performance.



Syndevco Inc.
 ISO-9001-2000
 Certificate # A10995

Syndevco Inc.

Sheet: 040527

24205 Telegraph Rd - Southfield MI 48034
 Toll Free: (800) 356-2839 Local: (248) 356-2839 Fax: (248) 356-0928
 visit us at: www.syndevco.com



SGL Series Cable Assembly

DIMENSIONS - STRAIGHT

UNITS OF MEASURE: $\frac{\text{inches}}{\text{(mm)}}$

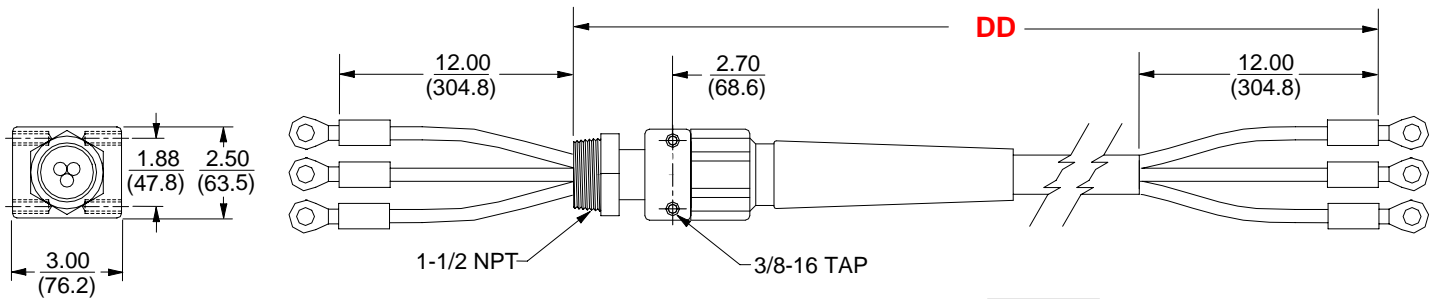

PART NUMBER SHOWN - **SGL22-00L00-FJ-DD**
DD in part number denotes length of cable in feet

CONDUCTOR COLOR
RED
BLACK
GREEN

PART NUMBER SYSTEM

GENERIC PART NUMBER : SGLAA-BBBBBB-CC-**DD**-E

SAMPLE PART NUMBER:	SGL12-00L00-FJ-25	GM STANDARD MDS610	90 DEGREE
	SGL22-00L00-FJ-25	GM STANDARD MDS610	STRAIGHT
	SGL12-00L00-FG-25	GM STANDARD MDS615	90 DEGREE
	SGL22-00L00-FG-25	GM STANDARD MDS615	STRAIGHT

SGL	AA		BBBBB		CC		DD		E
	CONNECTOR ANGLE				CABLE SIZE		LENGTH IN FEET		ADDITIONAL OPTIONS
12	90 DEGREE	00L00	GM STANDARD	FJ	2 AWG/ 3C.	25	GM STANDARD LENGTH	LEAVE BLANK FOR NONE OR SEE A SYNDEVCO REPRESENTATIVE	
22	STRAIGHT	SEE A SYNDEVCO REPRESENTATIVE FOR FURTHER OPTIONS		FG	4 AWG/ 3C.	CUSTOM LENGTHS READILY AVAILABLE 3 FEET +		LEAVE BLANK FOR NONE OR SEE A SYNDEVCO REPRESENTATIVE	

Notice: The information contained herein is, to the best of our knowledge, true, accurate and reliable. Since procedures and conditions under which these products may be used are beyond our control, no warranty, expressed or implied, is made to their performance.



Syndevco Inc.

Sheet: 040527

24205 Telegraph Rd - Southfield MI 48034

Toll Free: (800) 356-2839 Local: (248) 356-2839 Fax: (248) 356-0928

visit us at: www.syndevco.com