



# Marquee Assemblies

**(248) 356-2839**

*Low cost marquees provide an efficient way of communicating status of a specified situation*

## FEATURES

- Low Cost
- Stop Light LED or Shape Light LED versions
- Long lasting LED lights
- Incandescent versions available
- 1 to 24 cells
- Custom labeling to specifications
- 120VAC or 24VDC versions
- Electrical connection on bottom, top or side
- Custom wiring to specifications
- Additional options such as horns, multiple tone horns, speakers, push button testers, side terminal box, I/O blocks

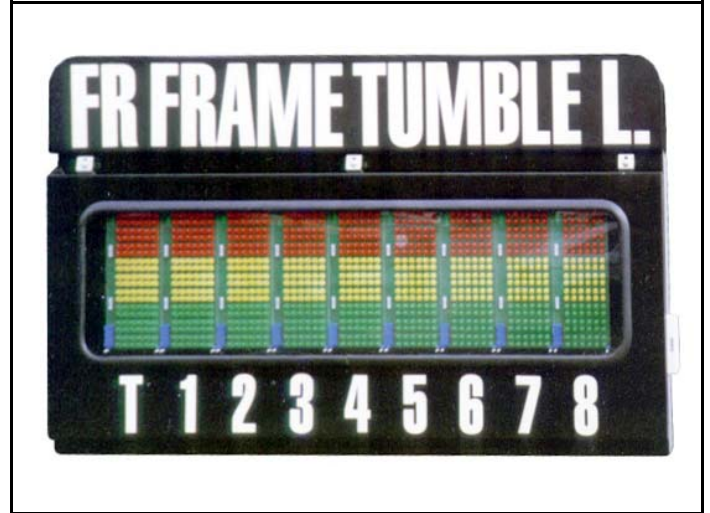

## DIMENSIONS

### Stop Light LED Version

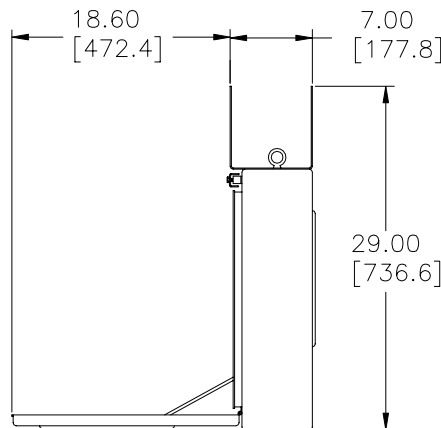
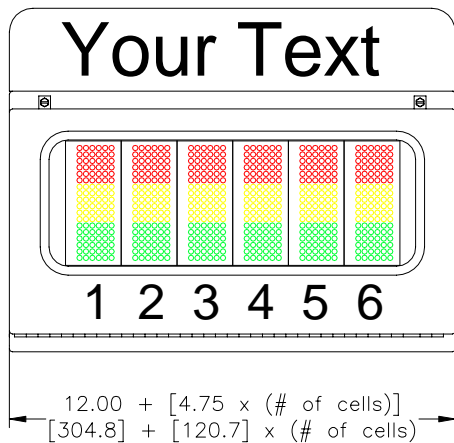

### Shape LED Version

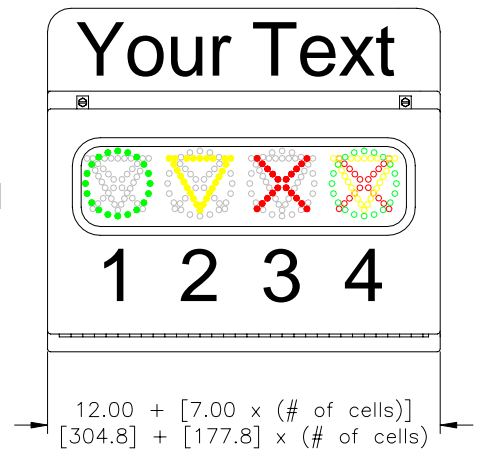

Units of Measure: inches  
[mm]

Notice: The information contained herein is, to the best of our knowledge, true, accurate and reliable. Since procedures and conditions under which these products may be used are beyond our control, no warranty, expressed or implied, is made to their performance.



**Syndevco Inc.** Sheet: 040120  
24205 Telegraph Rd - Southfield MI 48034  
Toll Free: (800) 356-2839 Local: (248) 356-2839 Fax: (248) 356-0928  
visit us at: [www.syndevco.com](http://www.syndevco.com)



# Marquee Assemblies

## OPTIONS

### Indicators

#### Light Configuration

- Stop Light
- Shape Light

#### Qty of Cells

- 1 cell thru 24 cells

#### Labeling

- Per customer specification

### Electrical

#### Mount Position

- Top
- LH or RH Side
- Bottom

#### Connector Type

- Hardwire
- Pigtail
- Receptacle (A, X, V- line, Pyle, Harting, etc.)

#### Wiring

- Per customer specification

### Additional Options

- Horns
- Speakers
- Push button testers
- Side terminal box
- I/O blocks

**Please see some of our other products for further design solutions**



UH series  
Utility Clamp



GTP Series  
Power Distribution  
Boxes

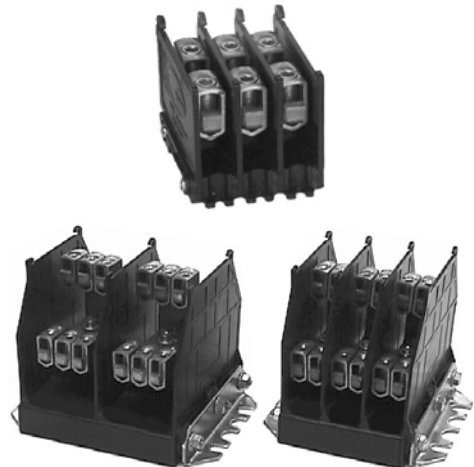

Terminal Blocks

Notice: The information contained herein is, to the best of our knowledge, true, accurate and reliable. Since procedures and conditions under which these products may be used are beyond our control, no warranty, expressed or implied, is made to their performance.



Syndevco Inc.  
ISO-9001-2000  
Certificate # A10995

**Syndevco Inc.**

Sheet: 040120

24205 Telegraph Rd - Southfield MI 48034

Toll Free: (800) 356-2839 Local: (248) 356-2839 Fax: (248) 356-0928

visit us at: [www.syndevco.com](http://www.syndevco.com)